



**G**lidevale eaves ventilation systems have been designed to provide a range of solutions to introduce low level ventilation into roofspaces in an unobtrusive way.

## EAVES AND LOW LEVEL VENTILATION SYSTEMS



There are two primary methods of introducing the ventilation at low level either via the soffit in discrete units or continuous systems using the SV soffit range or over the fascia using the FV fascia range. All provide full compliance with BS 5250 Management of Moisture in Buildings, the primary means to comply with Building Regulations in the UK as well as providing driving rain and large insect resistance.

Once inside, it is important that the ventilation air actually reaches all parts of the roofspace to be able to remove high humidity air and reduce the risk of harmful condensation from forming. To ensure this occurs, the RV rafter tray range is available in a variety of styles to suit numerous applications and designed to ensure a clear, unobstructed path from SV or FV ventilators to the roofspace.



## FV FASCIA VENTILATORS

### Description, Applications

FV Fascia Ventilators are an unobtrusive method of providing ventilation in a range of eaves details, including those without a projecting soffit. They must always be used with RV Rafter Ventilators, to provide a continuous ventilation path from the roof void to the outside without impairing the weatherproof function of the structure, as required by BS 5250.

They can also be used where detailing is difficult and tile or slate ventilators are inappropriate, e.g. parapet walls, secret gutters, corbelled eaves and monopitch ridges. The FV250 Ventilator can also be used to ventilate flat roofs (see page 5).

#### FV100 Over Fascia Ventilator

Installed continuously, provides guaranteed actual ventilation opening of 10 000mm<sup>2</sup>/m. Fit with gutter bracket spacers (supplied separately) where necessary.

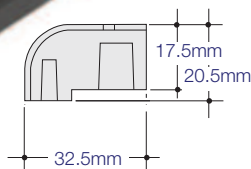

#### FV250 Over Fascia Ventilator

Installed continuously, provides guaranteed actual ventilation opening of 25 000mm<sup>2</sup>/m. Fit with gutter bracket spacers (supplied separately).

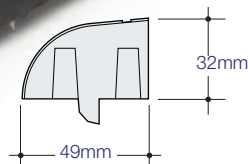

### Advantages

- Internal design provides effective resistance to both driving rain and large insects.
- Unobtrusive when fitted, hidden by gutter and roof covering.
- Can be used to provide ventilation above or below the underlay.
- Patented gutter bracket spacers ensure correct airflow behind the gutter.
- Lightweight and durable.
- Quick and easy to install, with no special tools required.
- Compatible with all roof tile clips and eaves comb fillers.
- Modular lengths allow adjustment for fascia board inaccuracies.
- Position on the fascia minimises the risk of fire spread to the roof space.
- Integral dovetail joints ensure positive and continuous interlock between units.
- Do not affect the slating/tiling process.

### Authority

Can be used to comply with roof space ventilation requirements of Building Regulations Approved Document C2 and BS 5250.

### Composition, Manufacture

Injection moulded black polypropylene. Gutter bracket spacers neutral grey. Supplied in 1m lengths.

Available as 12m or 45m pack.

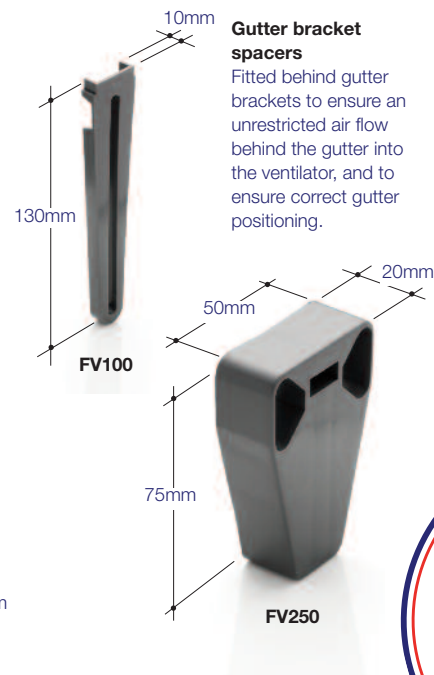

### Specification clauses

#### Eaves

Install Glidevale FV100/ FV250 Fascia Ventilators to provide eaves ventilation to the roof space equivalent to \_\_\_\_\_ mm<sup>2</sup>/m in accordance with Building Regulations Approved Document C2 2004 and 2010 & 2013 and BS 5250: 2021. Ventilators to have internal pin arrangement for resistance to driving rain and large insects. Install continuously on the two long edges of the roof/along the edges of the roof. Fix in accordance with manufacturer's instructions using gutter bracket spacers where necessary to ensure a clear air flow into the ventilator.

#### Monopitch ridge

Install Glidevale FV100 Ventilators at monopitch ridge to provide ventilation to the roof space equivalent to at least 5000mm<sup>2</sup>/m in accordance with Building Regulations Approved Document C2 2004 and 2010 & 2013 and BS 5250: 2021. Fix in accordance with manufacturer's instructions.

#### Flat roof

Install Glidevale FV250 Ventilators to provide ventilation to the roof space equivalent to 25 000mm<sup>2</sup>/m in accordance with Building Regulations Approved Document C2 2004 and 2010 & 2013 and BS 5250: 2021. Install continuously on the two long edges of the roof / at all abutments to walls. Fix in accordance with manufacturer's instructions.





## SV SOFFIT VENTILATORS

### Description, Applications

SV Soffit Ventilators are for installation at eaves with a projecting soffit, and must always be used with RV Rafter Ventilators to provide a continuous ventilation path from the roof void to the outside without impairing the weatherproof function of the structure, as required by BS 5250. SV120 and SV200 Soffit Ventilators are designed for easy installation in existing soffits, but can also be used in new work.

### Advantages

- Can be used with all common soffit board materials.
- Lightweight and durable.
- Quick and easy to install; no special tools required.
- Prevent large insect ingress.
- Independent of rafter spacing.
- Suitable for new roofs and refurbishment.
- Colours to match stained or painted soffit boards.

### Authority

Can be used to comply with roof space ventilation requirements of Building Regulations Approved Document C2 and BS 5250.

### Composition, Manufacture

All soffit strips are extruded PVC-U in 2.44m lengths. SV120, SV200 and SV604E Joint Connectors are injection-moulded polypropylene.

#### SV606

Provides guaranteed actual ventilation opening of 10 000mm<sup>2</sup>/m. For sloping soffits; can also be used without a soffit board, butted up to brickwork. White or brown.

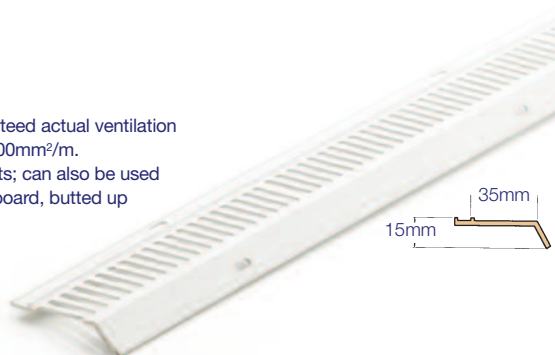

#### SV609

Provides guaranteed actual ventilation opening of 25 000mm<sup>2</sup>/m. For soffit boards 6 - 10mm thick. White or brown.

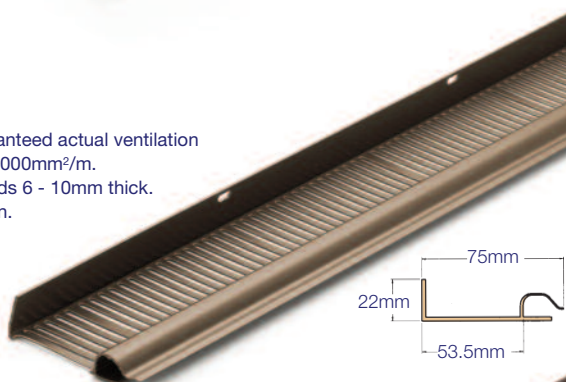

#### SV604E

Provides guaranteed actual ventilation opening of 10 000mm<sup>2</sup>/m. For soffit boards 6 - 10mm thick; will support a 6mm soffit board up to 300mm wide without additional noggings. Black, white or brown.



#### SV604E Expansion Joint Connector

Supplied with SV604E to allow thermal movement at straight joints, internal and external corners. Improves appearance by concealing cut edges, maintains large insect protection, and simply clips into position. Black, white or brown.

#### SV120 Spring Wing

Provides guaranteed actual ventilation opening of 10 000mm<sup>2</sup>/m at 1.2m centres. Spring clip fixing. For soffit boards 5 - 20mm thick. Hole size: 270 x 92mm (template supplied). White or brown.

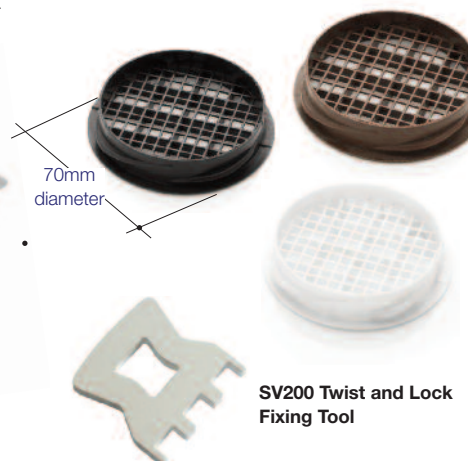
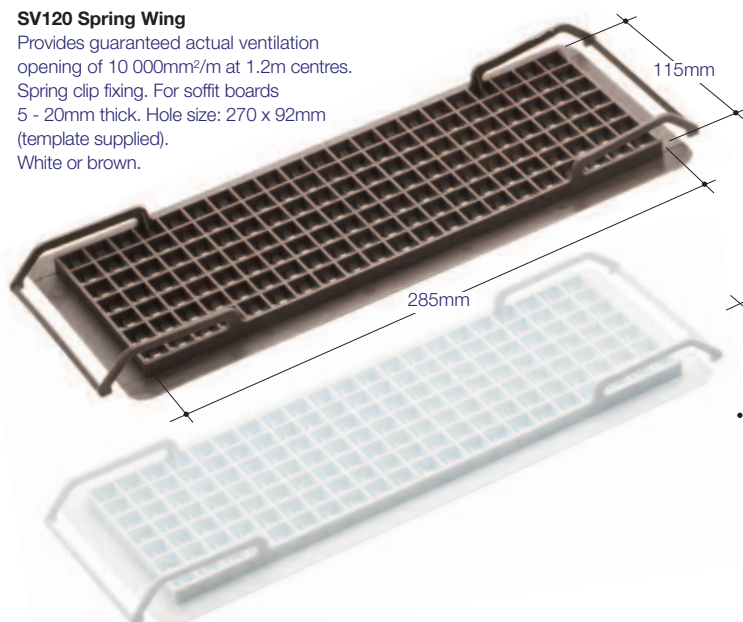

**SV200 Twist and Lock Fixing Tool**

### Specification clauses

#### Soffit strips

Install Glidevale SV604E/ SV606/ SV609 soffit ventilators to provide ventilation to the roof space equivalent to \_\_\_\_ mm<sup>2</sup>/m in accordance with Building Regulations Approved Document C2 2004 and 2010 & 2013 and BS 5250: 2021. Ventilators to be extruded PVC-U and designed to exclude large insects. Colour: black/ white/ brown. Install continuously on the two long edges of the roof / along the edges of the roof. Fix in accordance with manufacturer's instructions. SV604E only: fit Joint Connectors at every straight joint and every corner.

#### SV120 and SV200

Install Glidevale SV120/SV200 soffit ventilators at \_\_\_\_ mm centres to provide ventilation to the roof space equivalent to \_\_\_\_ mm<sup>2</sup>/m in accordance with Building Regulations Approved Document C2 2004 and 2010 & 2013 and BS 5250: 2021. Ventilators to be moulded polypropylene and designed to exclude large insects. Colour: black/ white/ brown. Install on the two long edges of the roof / along the edges of the roof. Fix in accordance with manufacturer's instructions.

#### SV200 Twist and Lock

Provides guaranteed actual ventilation opening of 10 000mm<sup>2</sup>/m at 200mm centres. Unique twist action fixing. For soffit boards from 6mm thick. Hole size: 70mm diameter. Hole saw and fixing tool available. Black, white or brown.

## RV RAFTER VENTILATORS

### Description, Applications

RV Rafter Ventilators are designed to ensure a clear air path between roof underlay and insulation at all types of eaves, in accordance with Building Regulations Approved Document C2. They should be installed continuously with FV Fascia Ventilators or SV Soffit Ventilators, to provide a continuous ventilation path from the roof void to the outside without impairing the weatherproof function of the structure, as required by BS 5250.

### Advantages

- Do not affect the slating/tiling process.
- Unique cross strengthening ribs on rafter trays prevent the underlay from sagging and blocking the airflow.
- Reduce the risk of cold bridging by enabling insulation to be laid right into eaves.
- Lightweight and durable.
- Quick and easy to install, with no special tools required.
- Suit standard rafter spacings.
- Independent of SV and FV ventilators, enabling use with any depth of soffit.

### Authority

Can be used to comply with roof space ventilation requirements of Building Regulations Approved Document C2 and BS 5250.

### Composition, Manufacture

Vacuum-formed black PVC.

RV Roll - 12m pack.

RV451(F) / RV401(F) / RV635 / RV655 - 50 pack.

RV601(F) - 25 pack.

RV625(F) - 20 pack.

### Dimensions

Product code	Width*	Depth
RV601, RV601F	345mm, 350mm	25mm
RV451, RV451F	345mm, 350mm	25mm
RV401, RV401F	345mm, 350mm	25mm
RV300	300mm	25mm
RV450	450mm	25mm
RV600	600mm	25mm
RV900	900mm	25mm
RV625, RV625F	350mm	40mm
RV635	230mm	30mm
RV655	230mm	30mm

\* Distance up rafter

### RV601, RV451, RV401

Provides guaranteed actual ventilation opening of 10 000mm<sup>2</sup>/m.

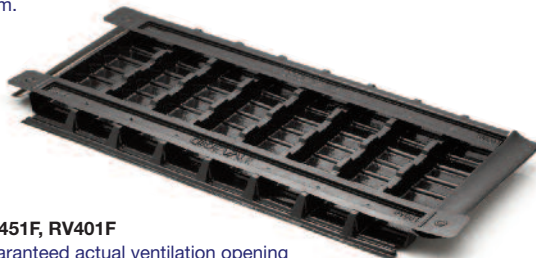

### RV601F, RV451F, RV401F

Provides guaranteed actual ventilation opening of 10 000mm<sup>2</sup>/m. For eaves with an open soffit, integral 4mm insect screen complies with BS 5250.



### RV Roll - RV300, RV450, RV600, RV900

Laid continuously over the rafters before the underlay is fixed, provides a maximum 25 000mm<sup>2</sup> dependent on eaves ventilation inlet provision. Universal, adjusts for 400 - 600mm rafter centres.

Available in 4 widths: 300mm, 450mm, 600mm and 900mm.

Rafter spacing	Effective coverage
600mm	10 rafter voids (6m)
450mm	13 rafter voids (6m)
400mm	15 rafter voids (6m)



### RV625, RV625F

Provides guaranteed actual ventilation opening of 25 000mm<sup>2</sup>/m at 600/450/400mm rafter centres, and a minimum gap of 25mm in accordance with BS 5250.

RV625F is for eaves with an open soffit; integral 4mm insect screen complies with BS 5250.

Designed for standard 600mm rafter centres, or can be easily cut to suit closer rafter spacings.



### RV635, RV655

Universal rafter trays which adjust to the correct roof pitch and can be used in new-build, or in refurbishment without disturbing the roof covering.

Provides guaranteed actual ventilation opening of 25 000mm<sup>2</sup>/m at 600mm rafter centres (RV655) or 400mm rafter centres (RV635).



### Eaves Pack

Two types of eaves packs are available;

#### EP10:

FV100 (1m x 6), Eaves Skirt (10 x ES60 contract eaves skirt) and RV300 (6m x 1).

#### EP25:

FV250 (1m x 6), Eaves Skirt (10 x ES60 contract eaves skirt) and RV450 (6m x 1).

### Specification clause

Install Glidevale RV \_\_\_\_\_ rafter ventilators to provide a continuous air path for roof space ventilation between roof insulation and roof underlay at eaves equivalent to \_\_\_\_\_mm<sup>2</sup>/m in accordance with Building Regulations Approved Document C2 2004 and 2010 & 2013 and BS 5250: 2021. Ventilators to be vacuum-formed PVC [and to have integral 4mm insect screen]. Install continuously on the two long edges of the roof / along the edges of the roof. Fix in accordance with manufacturer's instructions.



## TYPICAL DETAILS

**Cold roof with soffit ventilation**  
Type HR or LR underlay, ventilation 10 000mm<sup>2</sup>/m

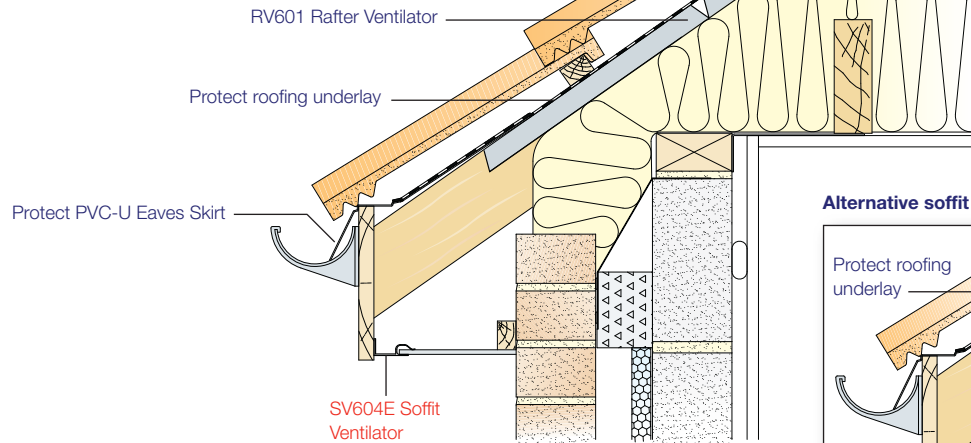

**Warm roof with fascia ventilation**  
Type HR underlay, ventilation 25 000mm<sup>2</sup>/m

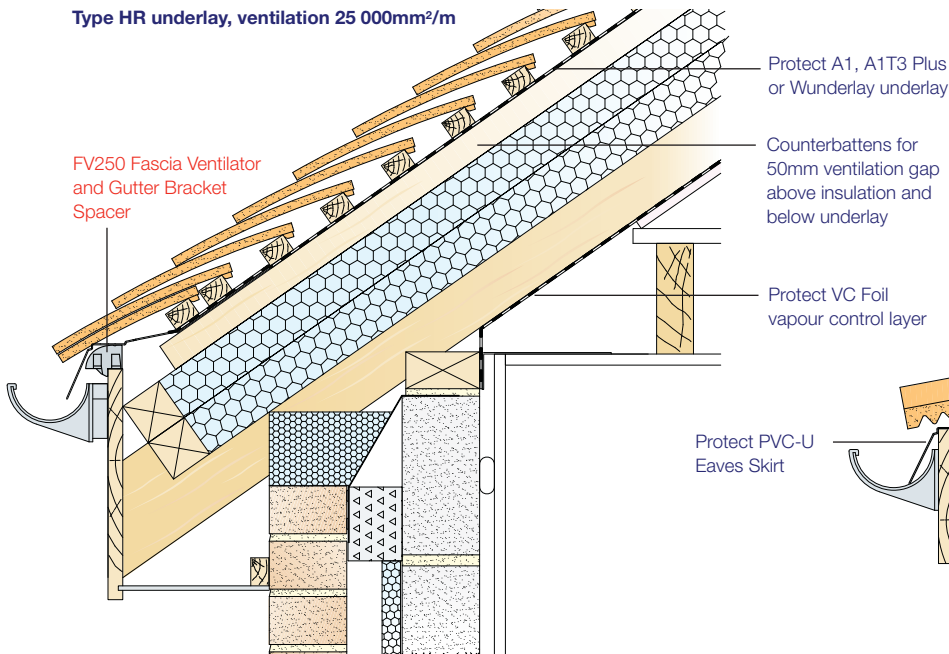

**Low-pitch roof with open soffit**  
Ventilation 25 000mm<sup>2</sup>/m

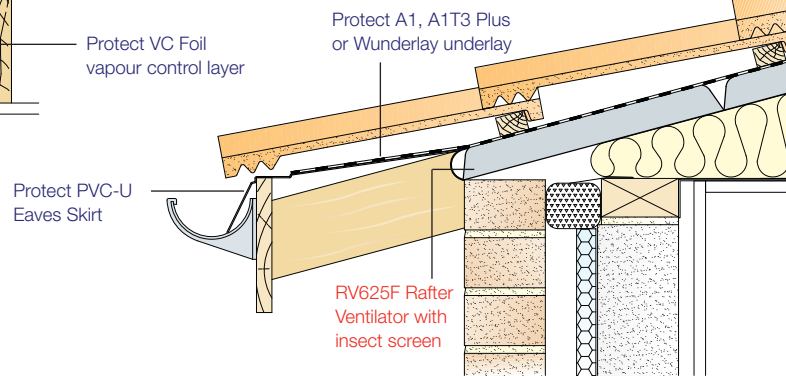

**Flat roof with wall abutment**  
Ventilation 25 000mm<sup>2</sup>/m at opposite edges

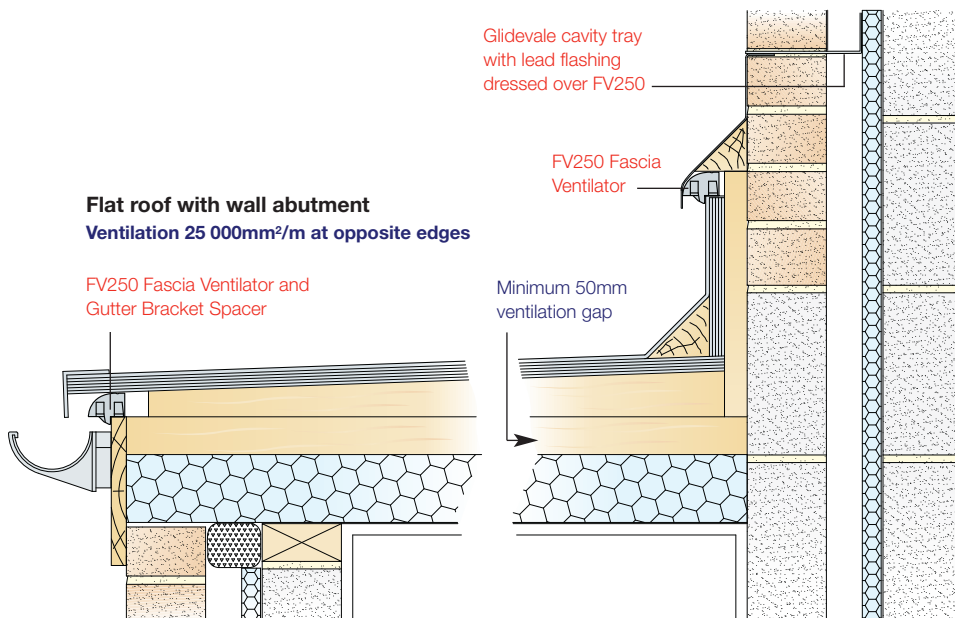



## ROOFING VENTILATION RANGE

Suitable for all tile and slate roofs, the wide array of Glidevale Protect ventilation products helps reduce the condensation risk for the full cold or warm roof structure, delivering the required airflow requirements when used in conjunction with roofing underlays.

*The range includes:*

### G Range Slate & Tile Ventilators

#### In-Line® Slate, Tile & Ridge Ventilators

#### Universal In-Line® Slate & Tile Ventilators

#### Versa-Tile G5 Ventilator / Terminal

#### RV Rafter Ventilators

#### Fascia Ventilators

### Soffit Ventilators

#### Abutment Ventilator

#### Monovent (Lean to Roof) Ventilator

#### Fulmetal RediRoll Ventilated Dry Fix Ridge / Hip system

## A COMPREHENSIVE CHOICE OF ROOFING UNDERLAYS

Whatever your pitched roofing project, Glidevale Protect's broad collection of underlays has it covered. Providing the complete solution for all types of slate or tile roofs to meet the key requirements of water tightness, strong wind uplift resistance and condensation control, Glidevale Protect gives unrivalled choice in specification and complete peace of mind.

### Vapour Permeable & Airtight (Type LR)

Protect VP400 Plus LR  
Protect Zytec  
Protect VP300

### Impermeable & Airtight (Type HR)

Protect A1T3 Plus  
Protect A1  
Protect Wunderlay

### Air & Vapour Permeable (Type LR)

Protect Viking Air

## ROOFING ACCESSORIES RANGE

A full package of roofing accessories for all tile and slate roofs is also available, designed to complement the roofing product collection and offering an ideal alternative to traditional products.

*The range includes:*

### AluFlash lead-free alternative flashing

#### Universal Dry Verge Systems for slates and interlocking tiles

#### Universal Dry Fix Valley Trough

#### Universal Valley Trough

#### Universal Bonding Strip

#### OFV Eaves Skirt & Eaves Comb

#### Solar Inlet Terminal

## CONSTRUCTION DIVISION

A whole range of product options are available from Glidevale Protect's Construction Division. This includes a range of external wall membranes, internal airtightness and vapour control membranes for walls, floors and ceilings, sealing tapes, cavity trays, underfloor and cavity wall ventilation, intelligent passive stack ventilation - iPSV®, trickle vents and loft access hatches.

### Glidevale Protect has it covered.

For more information, visit our website at:  
[www.glidevaleprotect.com](http://www.glidevaleprotect.com)

For further, detailed technical advice please contact the Glidevale Protect Technical department at:  
[technical@glidevaleprotect.com](mailto:technical@glidevaleprotect.com)

Stockist's stamp

## GLIDEVALE PROTECT

2 Brooklands Road, Sale, Cheshire M33 3SS  
T: +44 (0)161 905 5700 F: +44 (0)161 905 2085  
E: [info@glidevaleprotect.com](mailto:info@glidevaleprotect.com)  
W: [glidevaleprotect.com](http://glidevaleprotect.com)

Glidevale Protect maintains a policy of continuous development and reserves the right to amend product specifications without notice.



A division of Building Product Design Ltd. Company Registration No: 3944123